

PROMATECT®-H 4-hour fire rated self-supporting ceiling membrane (Type 1)

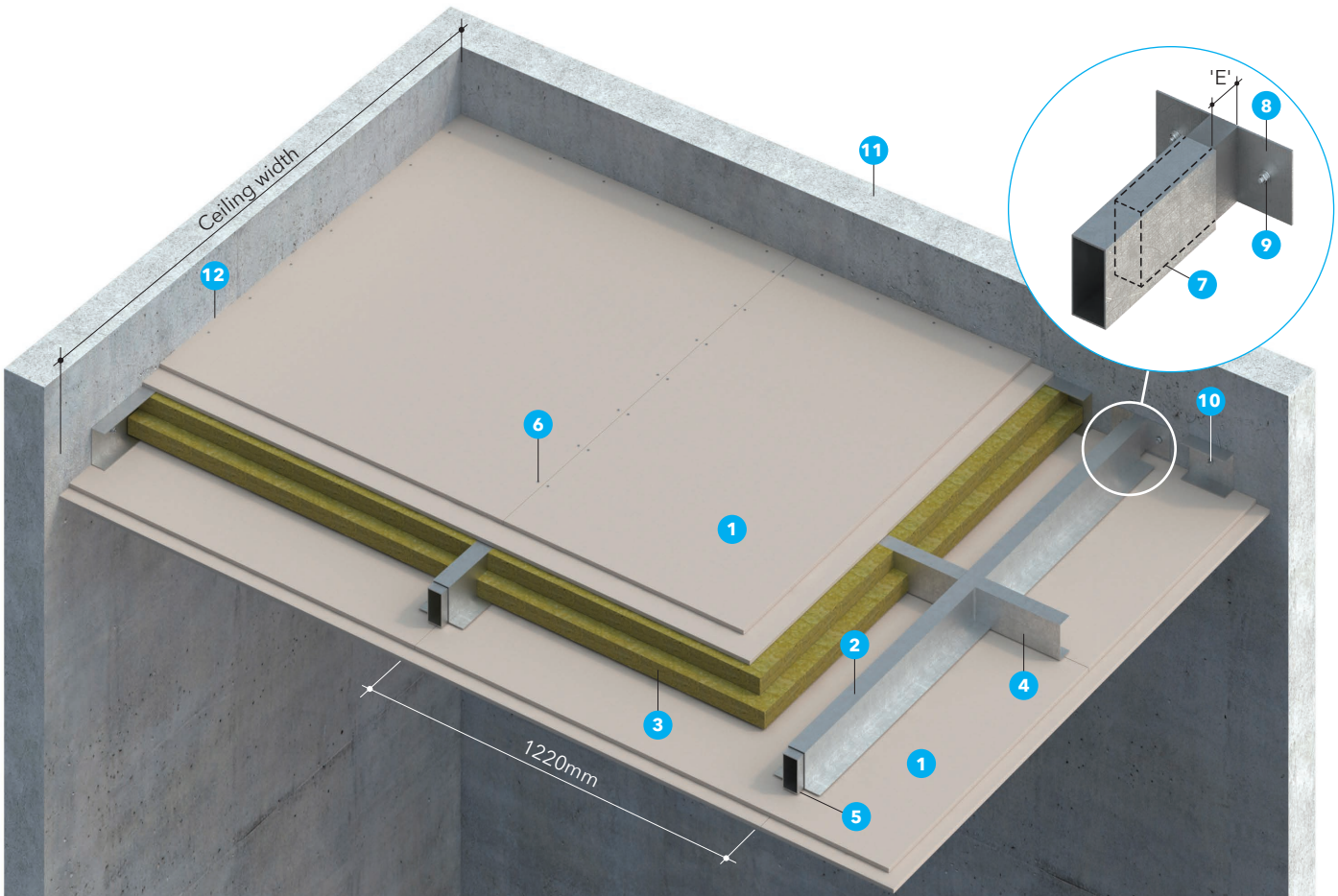
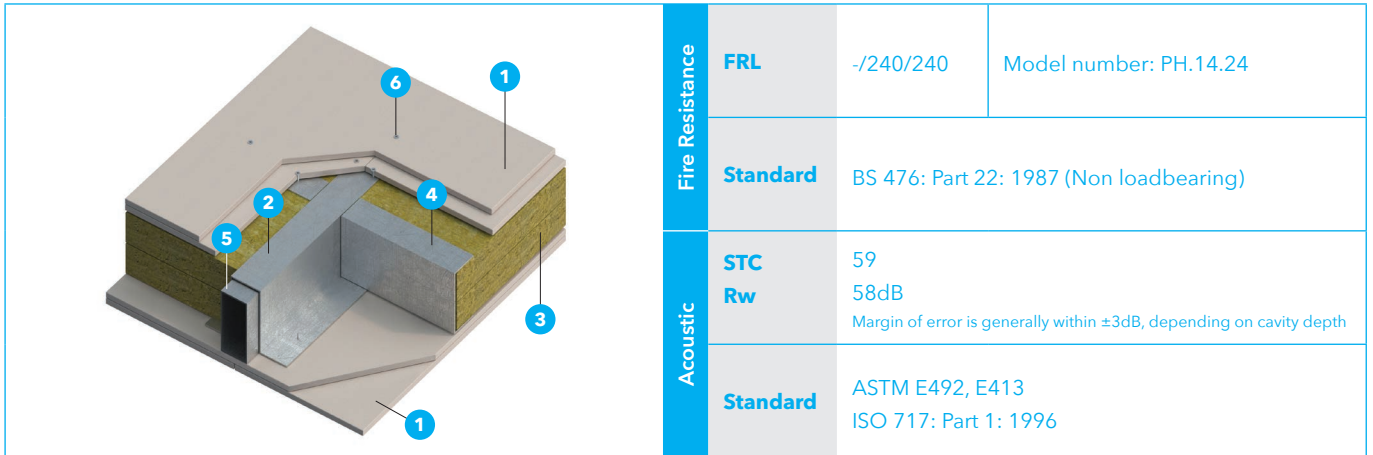

1. Two layers of PROMATECT®-H 12mm thick staggered joints min. 300mm between boards.
2. Galvanised steel top hat section 1.2mm thick.
3. Mineral wool 100mm x 100kg/m³
4. Channel C 100 x 50 x 1.2mm thick at 610mm centres.
5. Main support RHS 100 x 50 x 3mm at max. 1220mm centres for ceiling width up to 3m.
6. Self-tapping screw M4 x 25mm at 300mm centres for inner board and M4 x 38mm at 200mm centres for outer board.
7. RHS bracket fully welded to end plate (note 8).

8. Steel plate min 4.0mm thick.
9. M12 anchor bolts to fix note 8.
10. M6 anchor bolts at 600mm centres.
11. Masonry wall.
12. PROMASEAL®-A Acrylic Sealant to seal gaps on irregularities surface.

FRL (hour)	Expansion gap 'E'
4	10mm/m

Note: Please consult Promat for ceiling's width larger than 3m.

PROMATECT®-H 4-hour fire rated self-supporting ceiling membrane (Type 2)

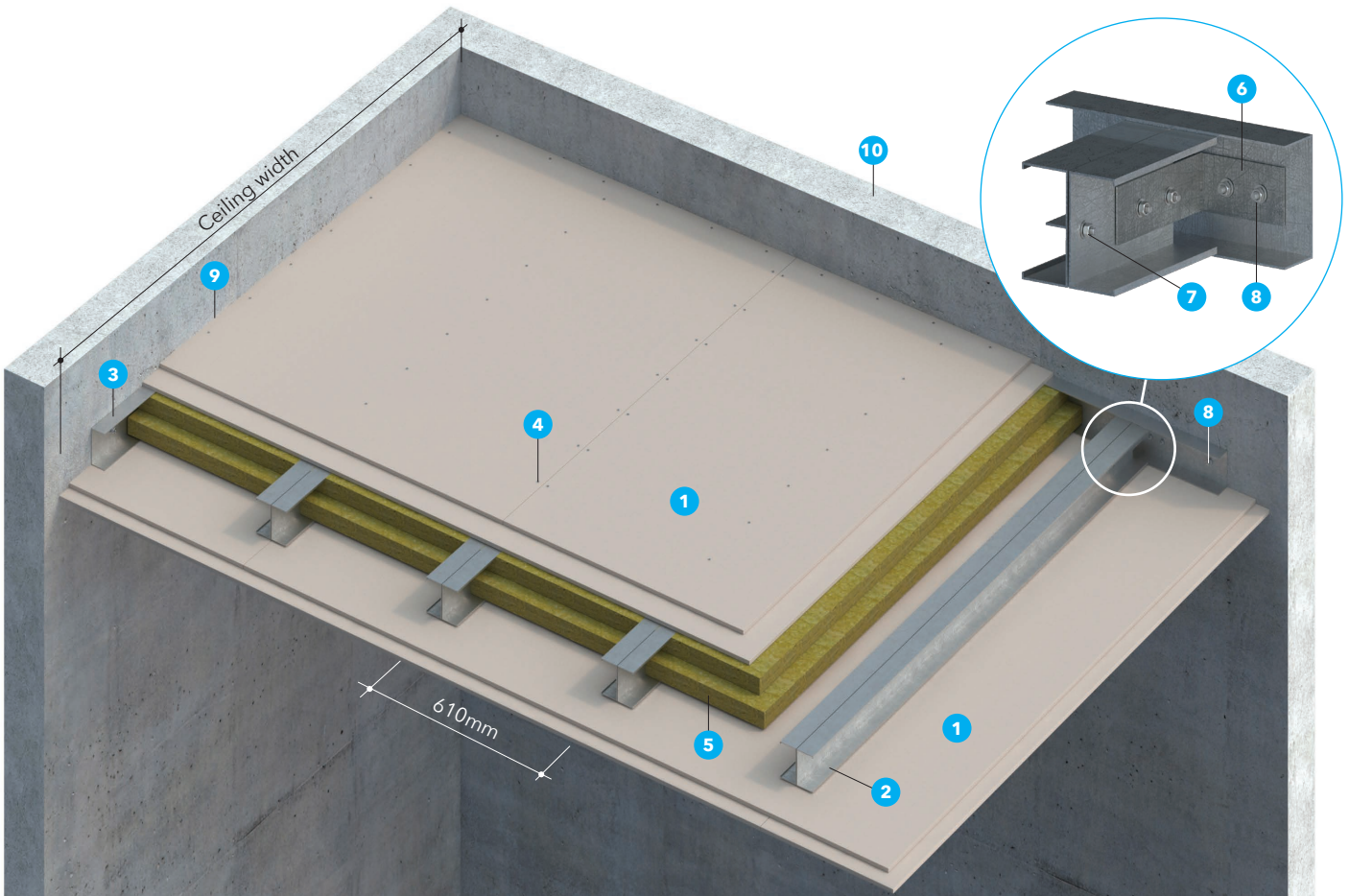
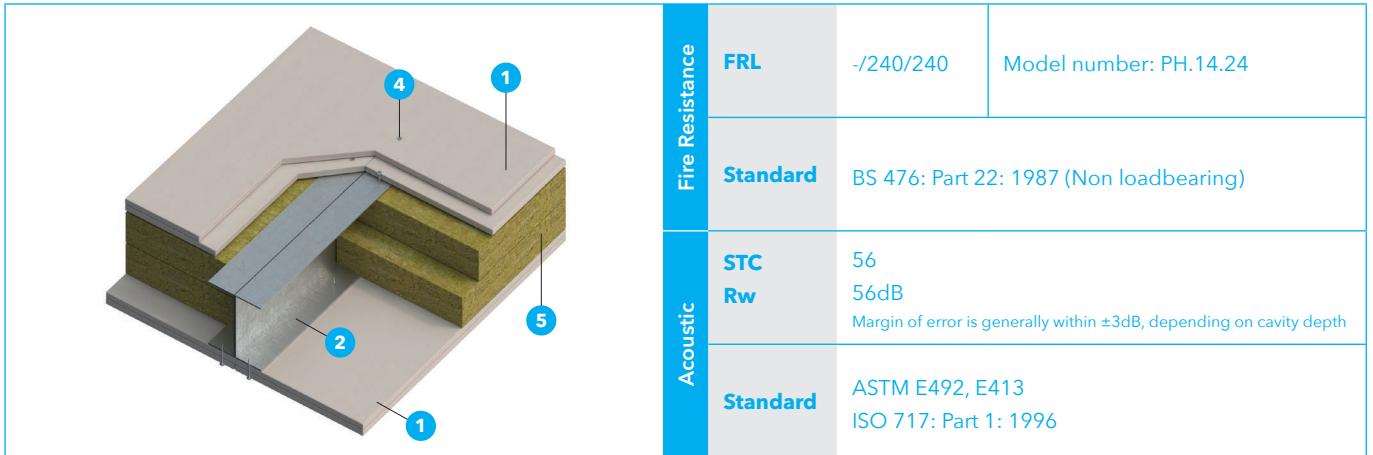

1. Two layers of PROMATECT®-H 12mm thick staggered joints min. 300mm between boards.
2. Back to back C-channels C-101 x 51 x 1.6mm at 610mm centres.
3. Perimeter galvanised steel channel 108 x 51 x 1.6mm thick.
4. M4 self-tapping screws at 200mm centres.
5. Mineral wool 2 x 50mm x 100kg/m³
6. L-Angle bracket 150 x 100 x 50 x 5mm thick (on both sides)
7. M10 bolt and nut at 500mm centres for back to back channel supports.
8. M10 all steel anchor bolts at 600mm centres.
9. PROMASEAL®-A Acrylic Sealant to seal gaps on irregularities surface.
10. Masonry wall.

Note: Please consult Promat for ceiling's width larger than 3m.