



Fire Test	FRL	-/60/60 -/120/120
	Standard	BS 476: Part 22: 1987
Acoustic performance	STC R _w	35 (-/60/60) 36 (-/120/120) 35dB (-/60/60) 37dB (-/120/120) <i>Margin of error is generally within ±3</i>
	Standard	STC ASTM E90 ASTM E413 R _w ISO 10140: Part 2 ISO 717: Part 1
Construction	Length	Unlimited
	Thickness	Nominal 35mm (-/60/60) Nominal 50mm (-/120/120) <i>Varies if the height exceeds 4000mm</i>

- ① PROMATECT®-H board, thickness and requirements in accordance with table below, staggered joints between boards at minimum 300mm

FRL	Main board	System model code
-/60/60	Two layers of 20mm + 15mm thick	PH.23.60
-/120/120	Two layers of 25mm + 25mm thick	PH.23.12

- ② 50mm x 50mm x 1mm thick perimeter steel angles
- ③ Suitable length of M4 self-tapping screws at nominal 200mm centres for first layer boards fixed to angles or at nominal 300mm centres for second layer boards fixed to first layer boards
- ④ Suitable length of M6 anchor bolts at nominal 600mm centres
- ⑤ Mineral wool seal for irregular surface between the angles and masonry structure
- ⑥ Caulk all perimeter gaps between the boards and masonry structure with PROMASEAL®-A Sealant to achieve the required fire resistance and/or acoustic performance when necessary

Please consult Promat for the size of steel angles if the partition height exceeds 4000mm

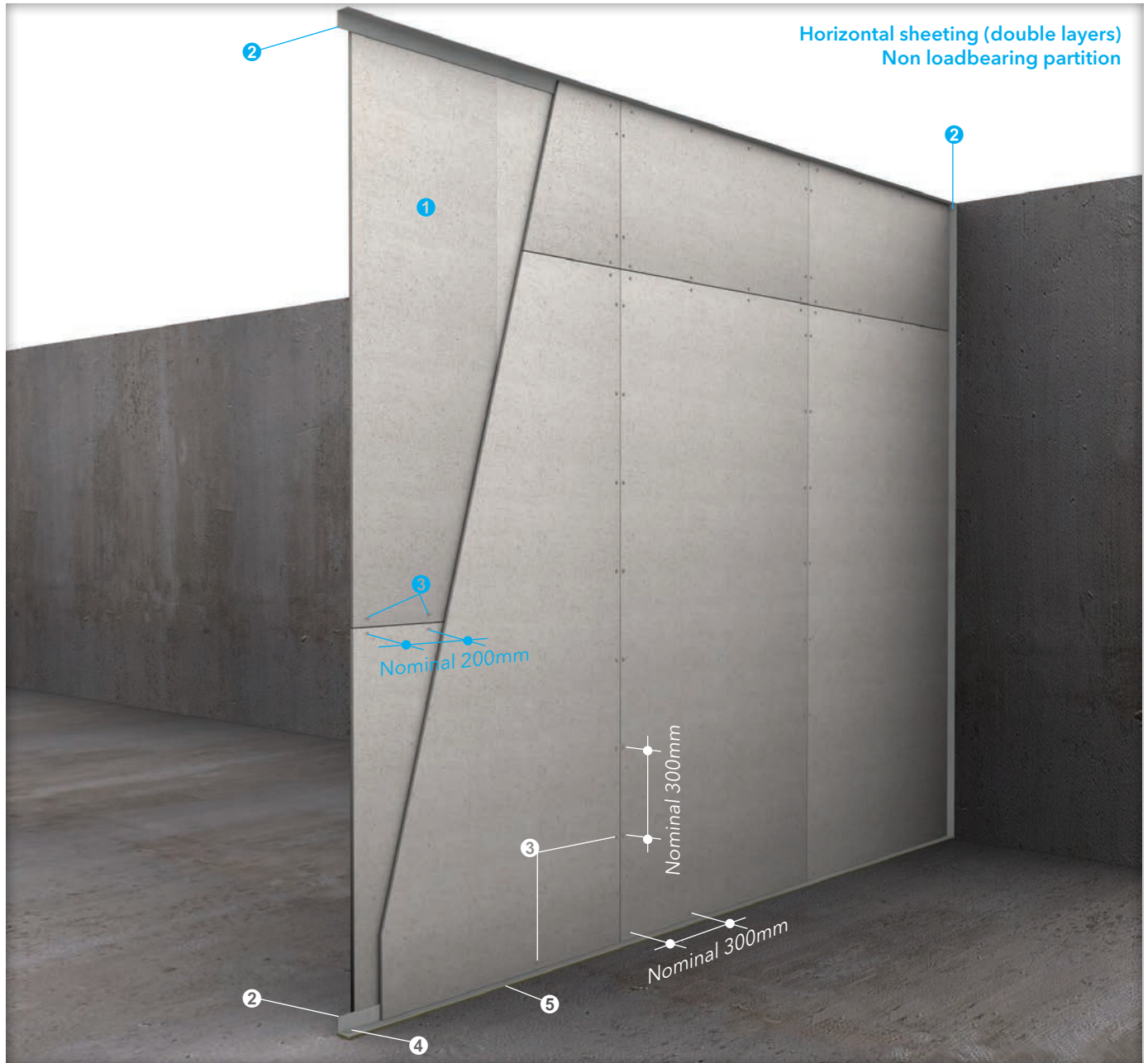

Performance specification for PH.23.60 | PH.23.12 solid/frameless internal partition

- PROMATECT®-H one and two-hour fire rated non-loadbearing solid/slim partition system constructed with two layers board - 15&20mm for one-hour, two hours 2-layer 25mm and relevant accessories tested to BS476: Part 22.
- Shall have a valid system's Certificate of Conformity (CoC) of Class 1/1A/ISO System 5 for fire performance of integrity and insulation for 60mins and 120mins when tested to BS476: Part 22.
- Shall have a valid material's Certificate of Conformity (CoC) Class 2 classification as EUROCLASS 'A1' when tested to EN13501-1 (equivalent to non-combustibility BS476: Parts 4).
- Shall be severe duty (SD) graded impact resistant when tested BS5234: Part 2 or SS 492.
- Shall hold a valid green label/mark issued by the SEC or SGBC.
- The board shall be matrix engineered mineral board, resistant to moisture, able to regain back its strength upon drying and has typical mechanical properties as seen on [page 6](#).